

Premier Frameless Pivot Unequal Alcove Showers

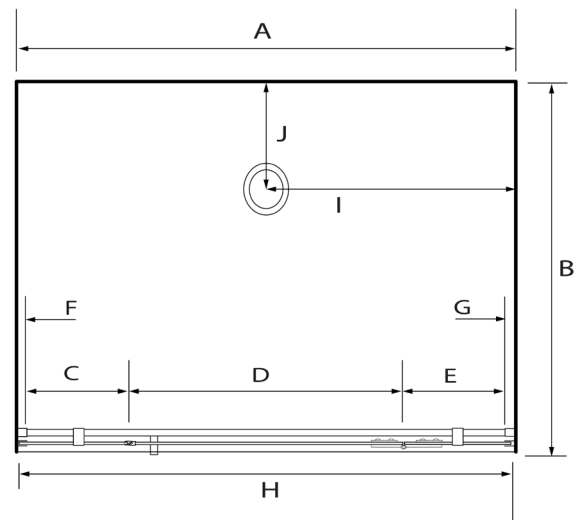

Alcove
1000 x 1200 x 1000
Silva FW



Alcove
900 x 1800 x 900
Black FW

DESCRIPTION

The Premier Frameless Pivot Alcove range of showers can be purchased as a complete shower cubicle including Acrylic Tray, Wall Liner and Door Pack.

The Door Pack and Tray can also be purchased as individual items for installation on a tiled floor and/or tiled wall.

SEE TILE SHOWER LAYOUT FOR SETOUT DIMENSIONS

The door is reversible - and closes to the glass return.

FEATURES

- Frameless design but fully watertight seals on door
- Total OVERALL height 2060mm
- 2000mm high glass
- Silver or Black extrusions and hardware
- Low profile tray with 40mm upstand
- 8mm Safety Glass
- Door closes to glass return
- Minimalistic extrusion allows adjustment to wall and floor
- No silicone joints required for glass

LEGEND

[illegible]

ORDERING CODES

PRODUCT DESCRIPTION	SHOWER SIZE				
	800x1200x800 1200 Door	900x1200x900 1200 Door	1200x900x1200 900 Door	1000x1200x1000 1200 Door	1000x1400x1000 1400 Door
Complete Cubicle SILVA	SPF8X12X8SIFW	SPF9X12X9SIFW	SPF12X9X12SIFW	SPF1X12X1SIFW	SPF1X14X1SIFW
Complete Cubicle BLACK	SPF8X12X8BLFW	SPF9X12X9BLFW	SPF12X9X12BLFW	SPF1X12X1BLFW	SPF1X14X1BLFW
Tray Only Centre Waste	TFS8X12X8ALCRCW	TFS9X12X9ALCRCW	TFS12X9X12ALCRCW	TFS1X12X1ALCRCW	TFS1X14X1ALCRCW
Liner Only 2000mm High Flat	LB8X12X8FW3S2M	LB9X12X9FW3S2M	LB12X9X12FW3S2M	LB1X12X1FW3S2M	LB1X14X1FW3S2M
Door/Return Pack SILVA	DF1200ALC2MSYMP	DF1200ALC2MSYMP	DF900ALC2MSYMP	DF1200ALC2MSYMP	DF1400ALC2MSYMP
Door/Return Pack BLACK	DF1200ALC2MBLKSYP	DF1200ALC2MBLKSYP	DF900ALC2MBLKSYP	DF1200ALC2MBLKSYP	DF1400ALC2MBLACKSYP

	900x1500x900 1500 Door	900x1600x900 1600 Door	900x1700x900 1700 Door	900x1800x900 1800 Door	
Complete Cubicle SILVA	SPF9X15X9SIFW	SPF9X16X9SIFW	SPF9X17X9SIFW	SPF9X18X9SIFW	
Complete Cubicle BLACK	SPF9X15X9BLFW	SPF9X16X9BLFW	SPF9X17X9BLFW	SPF9X18X9BLFW	
Tray Only Centre Waste	TFS9X15X9ALCRCW	TFS9X16X9ALCRCW	TFS9X17X9ALCRCW	TFS9X18X9ALCRCW	
Liner Only 2000mm High Flat	LB9X15X9FW3S2M	LB9X16X9FW3S2M	LB9X17X9FW3S2M	LB9X18X9FW3S2M	
Door/Return Pack SILVA	DF1500ALC2MSYMP	DF1600ALC2MSYMP	DF1700ALC2MSYMP	DF1800ALC2MSYMP	
Door/Return Pack BLACK	DF1500ALC2MBLKSYP	DF1600ALC2MBLKSYP	DF1700ALC2MBLKSYP	DF1800ALC2MBLKSYP	

WARRANTY INFORMATION

All bathroomware products supplied by Fibre Systems carry our Quality Assurance and Product Warranty. We use the highest quality materials available and manufacture these in accordance with New Zealand specifications and requirements to ensure that all products are fit for the intended purpose for which they are designed. Our customers peace of mind is of paramount importance to us.

Warranty Periods

Showers	10 years
Drop In baths	10 years
Shower Screens and Doors	10 years
Black Coating on Framework	5 years
Freestanding Baths	5 years
Accessories	2 years

Warranty Exclusions

The product must be installed according to the instructions supplied.

The water supply temperature applied to the product must not exceed 55 degrees Celsius.

Commercial applications (where products are installed in a building where occupancy is via a commercial arrangement i.e. rental property, hotel, hostel etc.) are restricted to a 2 year warranty on all products.



CLEANING AND MAINTENANCE

Bathroom products are used often and the following is our suggestion on how to clean and care for them.

Shower Wall

We use Durosan premium quality sanitaryware grade Acrylic. It is, by design, very robust and chemical resistant. A soft damp cloth with non-abrasive cleaners should be used. Use only non-abrasive cleaners that are recommended for acrylic products.

Shower Tray and Bath

We manufacture our Shower Trays and Baths using a Solid Acrylic Surface. Most other shower trays are manufactured using a veneer acrylic surface. The great advantage is that small scratches can be removed easily by using fine cutting compound. Again, the same basic cleaning methods as the wall are recommended.

Shower Doors and Glass

All glass is compliant to AS/NZS 2208. We suggest that the glass surfaces are wiped down or squeegeed following use to remove excess water. For best results use a trusted glass cleaner.

Metal Framework

Should be cleaned using a soft damp cloth with non-abrasive cleaner. Note that on round showers, the bottom rollers are easy release for ease of cleaning. If chemical spray cleaners are used, avoid direct contact with the rollers and guides and ensure the shower is rinsed off to avoid residue build up.

Weather Seals and Drip Strips

Can be removed if required for cleaning, and can be replaced when they no longer look their best. Refer to the spare parts and accessories section of our website for more details.

Note - If the Glass has been treated follow specific cleaning instructions from the system provider.