

# RETRO ALCOVE UNEQUAL 3 PANEL DOOR SHOWERS

## LOW HEIGHT



Pictured above - Retro 900 x1200 x 900 Alcove 3 Panel Stacker Flat Wall Silva

**SKU RA9X12X9SIFWS18**

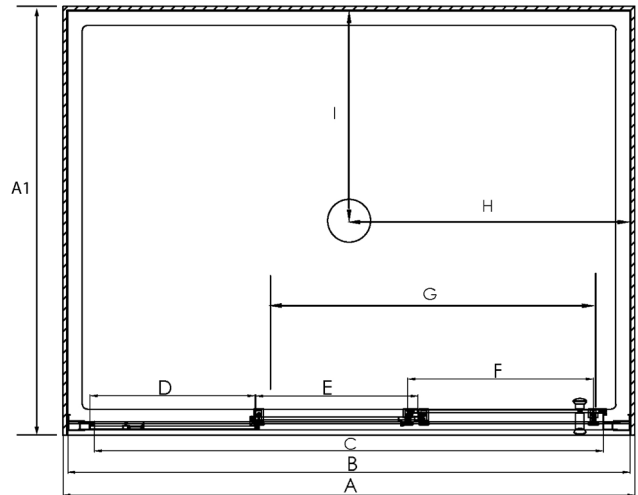

### DESCRIPTION

The Retro Alcove range of 3 Panel Stacker Door Showers can be purchased as a complete shower cubicle including acrylic tray, wall liner and door pack.

The door pack can also be purchased as an individual item for installation on a tiled floor and/or wall.

SEE TILE SHOWER LAYOUT FOR SETOUT DIMENSIONS

The door is reversible - and closes to the finished wall.

### FEATURES

- Total OVERALL height 1900mm
- Low profile tray with 40mm upstand
- 1830mm high glass
- 6mm Safety Glass compliant to NZ Safety Standard AS/NZ S2208
- Extrusions allow for adjustment to wall and floor
- High quality hardware
- Door is reversible and can open left to right or right to left

### LEGEND

Dimension	Description	Shower Size			
		760x900x-760mm	800x1200x-800mm	900x1200x-900mm	1000x1200x-1000mm
A	Tray External Width	900mm	1200mm	1200mm	1200mm
A1	Tray External Depth	760mm	800mm	900mm	1000mm
B	Door Frame Outer Dimension (including receivers)	875mm	1175mm	1175mm	1175mm
C	Door Frame Inner Dimension	768mm	1068mm	1068mm	1068mm
D	Fixed Glass Panel Width	246mm	346mm	346mm	346mm
E	Centre Sliding Panel Width	240mm	340mm	340mm	340mm
F	Outer Sliding Panel Width	289mm	389mm	389mm	389mm
G	Overall Door Opening Width	417mm	617mm	617mm	617mm
H	Waste Position from Outside of Tray	450mm	600mm	600mm	600mm
I	Waste Position From Outside of Tray	450mm	250mm	250mm	250mm

## ORDERING CODES

Product Description	Shower Size			
	760 x 900 x 760	800 x 1200 x 800	900 x 1200 x 900	1000 x 1200 x 1000
Square 3 Sided Alcove Flat Wall Silva 3 Panel Sliding Stacker Door	RA7X9X7SIFWS18	RABX12X8SIFWS18	RA9X12X9SIFWS18	RA1X12X1SIFWS18
Flat Alcove Tray Only	TFS7X9X7ALCCW	TFS8X12X8ALCRCW	TFS9X12X9ALCRCW	TFS1X12X1ALCRCW
Flat Alcove Wall Liner Only White 1830mm High	LB7X9X7FW3S18	LB8X12X8FW3S18	LB9X12X9FW3S18	LB1X12X1FW3S18
3 Panel Sliding Stacker Door Only Silva 1830mm High	D3PS900S18SYMP	D3PS1200S18SYMP	D3PS1200S18SYMP	D3PS1200S18SYMP

## WARRANTY INFORMATION

All bathroomware products supplied by Fibre Systems carry our Quality Assurance and Product Warranty. We use the highest quality materials available and manufacture these in accordance with New Zealand specifications and requirements to ensure that all products are fit for the intended purpose for which they are designed. Our customers peace of mind is of paramount importance to us.

### Warranty Periods

Showers	10 years
Drop In baths	10 years
Showers Screens and Doors	10 years
Black Coating on Framework	5 years
Freestanding Baths	5 years
E-Line Range Showers	5 years
Accessories	2 years

### Warranty Exclusions

The product must be installed according to the instructions supplied.

The water supply temperature applied to the product must not exceed 55 degrees Celsius.

Commercial applications (where products are installed in a building where occupancy is via a commercial arrangement i.e. rental property, hotel, hostel etc.) are restricted to a 2 year warranty on all products.

## CLEANING AND MAINTENANCE

Bathroom products are used often and the following is our suggestion on how to clean and care for them.

### Shower Wall

We use Durosan premium quality sanitaryware grade Acrylic. It is, by design, very robust and chemical resistant. A soft damp cloth with non-abrasive cleaners should be used. Use only non-abrasive cleaners that are recommended for acrylic products.

### Shower Tray and Bath

We manufacture our Shower Trays and Baths using a Solid Acrylic Surface. Most other shower trays are manufactured using a veneer acrylic surface. The great advantage is that small scratches can be removed easily by using fine cutting compound. Again, the same basic cleaning methods as the wall are recommended.

### Shower Doors and Glass

All glass is compliant to AS/NZS 2208. We suggest that the glass surfaces are wiped down or squeegeed following use to remove excess water. For best results use a trusted glass cleaner.

### Metal Framework

Should be cleaned using a soft damp cloth with non-abrasive cleaner. Note that on round showers, the bottom rollers are easy release for ease of cleaning. If chemical spray cleaners are used, avoid direct contact with the rollers and guides and ensure the shower is rinsed off to avoid residue build up.

### Weather Seals and Drip Strips

Can be removed if required for cleaning, and can be replaced when they no longer look their best. Refer to the spare parts and accessories section of our website for more details.

**Note - If the Glass has been treated follow specific cleaning instructions from the system provider.**