

AQUERO 12 x 9 PIVOT DOOR SHOWERS

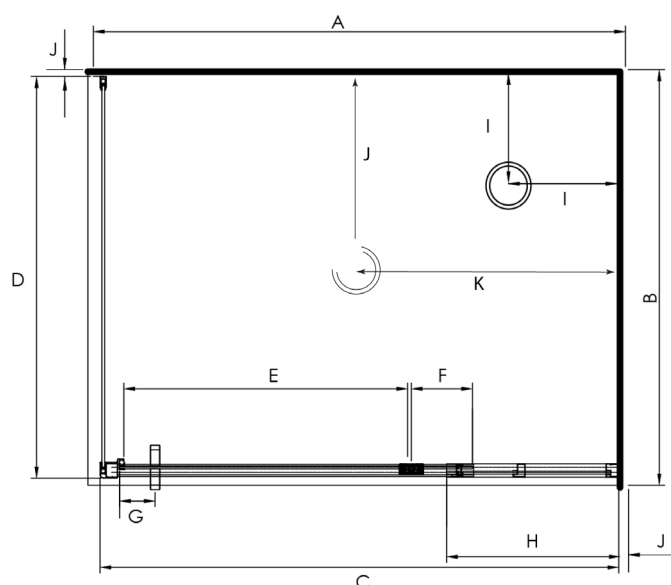

Pictured - Aquero 1200 x 900 Pivot Door
Left Hand Tray Configuration Flat Wall Silva
SKU 3614511



DESCRIPTION

The Aquero Range of Pivot Door Showers can be purchased as a complete Shower Cubicle including Acrylic Tray, Wall Liner and Door Pack.

The Door Pack and Tray can also be purchased as individual items for installation on a tiled floor and/or wall.

SEE TILE SHOWER LAYOUT FOR SETOUT DIMENSIONS

The door opening direction is reversible

FEATURES

- Total OVERALL height 2020mm
- Available in Silva and White
- Low profile tray with 40mm upstand
- 1950mm high glass
- Pivot door in a modern 1 piece design with 6mm Safety Glass
- Extrusions allow for adjustment to wall and floor
- High quality hardware
- Door can be ordered on 900mm side as an optional extra (surcharge applies)

LEGEND

Dimension	Description	Capricorn Shower Size	
		1200 x 900 1200 Door	1200 x 900 900 Door
A	Tray External Length Dimension	1200mm	1200mm
B	Tray External Width Dimension	900mm	900mm
C	Door Frame Dimension	1170mm	870mm
D	Return Panel Dimension	870mm	1170mm
E	Door Opening Dimension	640mm	640mm
F	Centre of Pivot Block to Edge of Door Glass	138mm	138mm
G	Centre of Handle to Edge of Door	80mm	80mm
H	Return Glass Panel Dimension	389mm	N/A
I	Waste position (Corner)	250mm	250mm
J	Waste position (Centre)	450mm	600mm
K	Waste position (Centre)	600mm	450mm

ORDERING CODES

Product	SKU CODE			
	1200 X 900 LH 1200mm Door	1200 X 900 RH 1200mm Door	1200 X 900 LH 900mm Door	1200 X 900 RH 900mm Door
Complete Cubicle 2 Sided Flat Wall White Pivot Door	3614509	3614513	3614509*	3614513*
Complete Cubicle 2 Sided Flat Wall Silva Pivot Door	3614511	3614515	3614511*	3614515*
Complete Cubicle 2 Sided Moulded (1200 side) Back Wall White Pivot Door	3614510	3614514	3614510*	3614514*
Complete Cubicle 2 Sided Moulded (1200 side) Back Wall Silva Pivot Door	3614512	3614516	3614512*	3614516*
Flat Tray Only (Corner Waste)	TFS12X9LHCNR	TFS12X9RHCNR	TFS12X9LHCNR	TFS12X9RHCNR
Flat Tray Only (Centre Waste)	TFS12X9LHCW	TFS12X9RHCW	TFS12X9LHCW	TFS12X9RHCW
Flat 2 Sided Wall Liner Only White 1950mm High	LB12X9FW2S195	LB12X9FW2S195	LB12X9FW2S195	LB12X9FW2S195
Moulded 2 sided Back Wall/ Wall Liner Only White 1950mm High	LB12X9MW2S195	LB12X9MW2S195	LB12X9MW2S195	LB12X9MW2S195
Pivot Door and Return Only White (reversible opening)	D12DX9RWH195	D12DX9RWH195	D9DX12RWH195	D9DX12RWH195
Pivot Door and Return Only Silva (reversible opening)	D12DX9RSI195	D12DX9RSI195	D9DX12RSI195	D9DX12RSI195
* Please specify 900 Door / 1200 Return on Order				

WARRANTY INFORMATION

All bathroomware products supplied by Fibre Systems carry our Quality Assurance and Product Warranty. We use the highest quality materials available and manufacture these in accordance with New Zealand specifications and requirements to ensure that all products are fit for the intended purpose for which they are designed. Our customers peace of mind is of paramount importance to us.

Warranty Periods

Showers	10 years
Drop In baths	10 years
Shower Screens and Doors	10 years
Black Coating on Framework	5 years
Freestanding Baths	5 years
Dezine Range Showers	5 years
Accessories	2 years

Warranty Exclusions

The product must be installed according to the instructions supplied.

The water supply temperature applied to the product must not exceed 55 degrees Celsius.

Commercial applications (where products are installed in a building where occupancy is via a commercial arrangement i.e. rental property, hotel, hostel etc.) are restricted to a 2 year warranty on all products.



CLEANING AND MAINTENANCE

Bathroom products are used often and the following is our suggestion on how to clean and care for them.

Shower Wall

We use Durosan premium quality sanitaryware grade Acrylic. It is, by design, very robust and chemical resistant. A soft damp cloth with non-abrasive cleaners should be used. Use only non-abrasive cleaners that are recommended for acrylic products.

Shower Tray and Bath

We manufacture our Shower Trays and Baths using a Solid Acrylic Surface. Most other shower trays are manufactured using a veneer acrylic surface. The great advantage is that small scratches can be removed easily by using fine cutting compound. Again, the same basic cleaning methods as the wall are recommended.

Shower Doors and Glass

All glass is compliant to AS/NZS 2208. We suggest that the glass surfaces are wiped down or squeegeed following use to remove excess water. For best results use a trusted glass cleaner.

Metal Framework

Should be cleaned using a soft damp cloth with non-abrasive cleaner. Note that on round showers, the bottom rollers are easy release for ease of cleaning. If chemical spray cleaners are used, avoid direct contact with the rollers and guides and ensure the shower is rinsed off to avoid residue build up.

Weather Seals and Drip Strips

Can be removed if required for cleaning, and can be replaced when they no longer look their best. Refer to the spare parts and accessories section of our website for more details.

Note - If the Glass has been treated follow specific cleaning instructions from the system provider.