

RETRO ALCOVE UNEQUAL 3 PANEL DOOR SHOWERS

LOW HEIGHT



Pictured above - Retro 900 x1200 x 900 Alcove 3 Panel Stacker Flat Wall Silva

SKU RA9X12X9SIFWS18

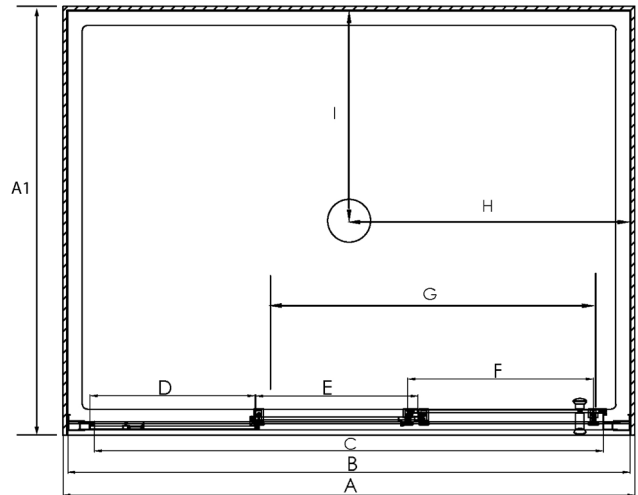

DESCRIPTION

The Retro Alcove range of 3 Panel Stacker Door Showers can be purchased as a complete shower cubicle including acrylic tray, wall liner and door pack.

The door pack can also be purchased as an individual item for installation on a tiled floor and/or wall.

SEE TILE SHOWER LAYOUT FOR SETOUT DIMENSIONS

The door is reversible - and closes to the finished wall.

FEATURES

- Total OVERALL height 1900mm
- Low profile tray with 40mm upstand
- 1830mm high glass
- 6mm Safety Glass compliant to NZ Safety Standard AS/NZ S2208
- Extrusions allow for adjustment to wall and floor
- High quality hardware
- Door is reversible and can open left to right or right to left

LEGEND

| Dimension | Description | Shower Size | | | |
|-----------|--|----------------|-----------------|-----------------|-------------------|
| | | 760x900x-760mm | 800x1200x-800mm | 900x1200x-900mm | 1000x1200x-1000mm |
| A | Tray External Width | 900mm | 1200mm | 1200mm | 1200mm |
| A1 | Tray External Depth | 760mm | 800mm | 900mm | 1000mm |
| B | Door Frame Outer Dimension (including receivers) | 875mm | 1175mm | 1175mm | 1175mm |
| C | Door Frame Inner Dimension | 768mm | 1068mm | 1068mm | 1068mm |
| D | Fixed Glass Panel Width | 246mm | 346mm | 346mm | 346mm |
| E | Centre Sliding Panel Width | 240mm | 340mm | 340mm | 340mm |
| F | Outer Sliding Panel Width | 289mm | 389mm | 389mm | 389mm |
| G | Overall Door Opening Width | 417mm | 617mm | 617mm | 617mm |
| H | Waste Position from Outside of Tray | 450mm | 600mm | 600mm | 600mm |
| I | Waste Position From Outside of Tray | 450mm | 250mm | 250mm | 250mm |

ORDERING CODES

| Product Description | Shower Size | | | |
|--|-----------------|------------------|------------------|--------------------|
| | 760 x 900 x 760 | 800 x 1200 x 800 | 900 x 1200 x 900 | 1000 x 1200 x 1000 |
| Square 3 Sided Alcove Flat Wall Silva 3 Panel Sliding Stacker Door | RA7X9X7SIFWS18 | RABX12X8SIFWS18 | RA9X12X9SIFWS18 | RA1X12X1SIFWS18 |
| Flat Alcove Tray Only | TFS7X9X7ALCCW | TFS8X12X8ALCRCW | TFS9X12X9ALCRCW | TFS1X12X1ALCRCW |
| Flat Alcove Wall Liner Only White 1830mm High | LB7X9X7FW3S18 | LB8X12X8FW3S18 | LB9X12X9FW3S18 | LB1X12X1FW3S18 |
| 3 Panel Sliding Stacker Door Only Silva 1830mm High | D3PS900S18SYMP | D3PS1200S18SYMP | D3PS1200S18SYMP | D3PS1200S18SYMP |

WARRANTY INFORMATION

All bathroomware products supplied by Fibre Systems carry our Quality Assurance and Product Warranty. We use the highest quality materials available and manufacture these in accordance with New Zealand specifications and requirements to ensure that all products are fit for the intended purpose for which they are designed. Our customer's peace of mind is of paramount importance to us.

Warranty Periods

| | |
|--------------------------------------|----------|
| Baths | 10 years |
| Showers | 10 years |
| Shower Screens and Doors | 10 years |
| Silva and White Coatings | 10 years |
| E-Line + Squareline + Dezine Showers | 5 years |
| Black Coatings | 5 years |
| Aquaknight Easy Clean Wastes | 7 years |
| Accessories | 2 years |



Warranty Exclusions

The product must be installed according to the instructions supplied.

The water supply temperature applied to the product must not exceed 55 degrees Celsius.

All cleaning and cleaning products must be in accordance with our cleaning instructions and guidance.

Commercial Applications (where products are installed in a building where occupancy is via a commercial arrangement i.e. a rental property, hotel, hostel etc) are restricted to a 2 year warranty on all products.

CLEANING AND MAINTENANCE

Please refer to our cleaning instructions document for guidance - available on our website.