

AQUERO SLIDING DOOR SHOWERS

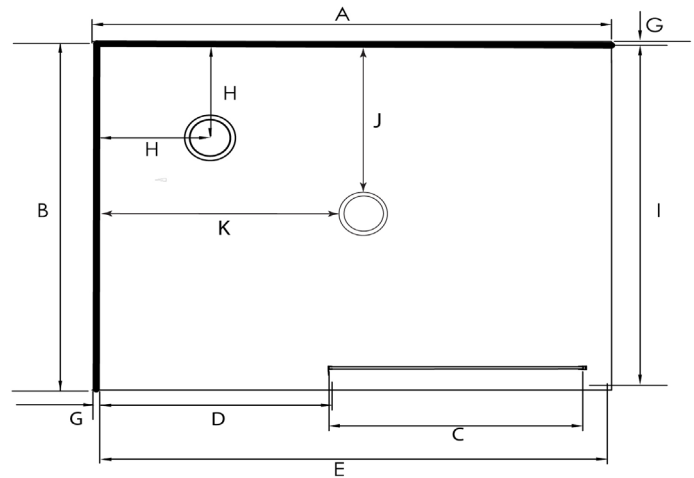

Pictured - Aquero 1200 x 900 2 Panel Sliding Door
Right Hand Tray Configuration Flat Wall Silva
SKU S12X9AQRSHSIFWZ



DESCRIPTION

The Aquero Range of 2 Panel Sliding Door Showers can be purchased as a complete shower cubicle including Acrylic Tray, Wall Liner and Door Pack.

The Door Pack and Tray can also be purchased as individual items for installation on a tiled floor and/or wall.

SEE TILE SHOWER LAYOUT FOR SETOUT DIMENSIONS

The door is reversible - and closes to the finished wall.

FEATURES

- Total OVERALL height 2020mm
- Low profile tray with 40mm upstand
- 1950mm high glass
- 6mm Safety Glass
- Door is reversible (can open from left to right and right to left)
- Doorset available in White, Silva and Black
- Extrusions allow for adjustment to wall and floor
- High quality stainless/allooy fittings and hardware

LEGEND

Dimension	Description	Shower Size	
		1200x800	1200x900
A	Tray Length External Dimension	1200mm	1200mm
B	Tray Depth External Dimension	800mm	900mm
C	Door Opening Dimension +/- 10mm	560mm	560mm
D	Small Return Panel Dimension	542mm	542mm
E	Door Panel Dimension	1186mm	1186mm
F	Large Return Panel Dimension	780mm	880mm
G	Gib Board + Glue + Liner Thickness	13mm	13mm
H	Corner Waste Position (from Framing)	250mm	250mm
I	Return Panel Dimension	770mm	870mm
J	Centre Waste Position	N/A	450mm
K	Centre Waste Position	N/A	600mm

ORDERING CODES

Product Description	SKU CODE	
	1200 x 800	1200 x 900
Complete Cubicle White Flat Wall Left Hand	S12X8AQLSHWHFWZ	S12X9AQLSHWHFWZ
Complete Cubicle White Flat Wall Right Hand	S12X8AQRSRHWHFWZ	S12X9AQRSRHWHFWZ
Complete Cubicle White Moulded Wall Left Hand	S12X8AQLSHWHMWZ	S12X9AQLSHWHMWZ
Complete Cubicle White Moulded Wall Right Hand	S12X8AQRSRHWHMWZ	S12X9AQRSRHWHMWZ
Complete Cubicle Silva Flat Wall Left Hand	S12X8AQLSHSIFWZ	S12X9AQLSHSIFWZ
Complete Cubicle Silva Flat Wall Right Hand	S12X8AQRSRHSHSIFWZ	S12X9AQRSRHSHSIFWZ
Complete Cubicle Silva Moulded Wall Left Hand	S12X8AQLSHSIMWZ	S12X9AQLSHSIMWZ
Complete Cubicle Silva Moulded Wall Right Hand	S12X8AQRSRHSHSIMWZ	S12X9AQRSRHSHSIMWZ
Complete Cubicle Black Flat Wall Left Hand	S12X8AQLSHBLFWZ	S12X9AQLSHBLFWZ
Complete Cubicle Black Flat Wall Right Hand	S12X8AQRSRHBLFWZ	S12X9AQRSRHBLFWZ
Complete Cubicle Black Moulded Wall Left Hand	S12X8AQLSHBLMWZ	S12X9AQLSHBLMWZ
Complete Cubicle Black Moulded Wall Right Hand	S12X8AQRSRHBLMWZ	S12X9AQRSRHBLMWZ
Tray Only Corner Waste White Left Hand	TFS12X8LHCNR	TFS12X9LHCNR
Tray Only Corner Waste White Right Hand	TFS12X8RHCNR	TFS12X9RHCNR
Tray Only Centre Waste White Left Hand	N/A	TFS12X9LHCW
Tray Only Centre Waste White Right Hand	N/A	TFS12X9RHCW
Liner Only Flat Wall 1950mm High 2 Sided White	LB12X8FW2S195	LB12X9FW2S195
Liner Only Moulded Wall 1950mm High 2 Sided White	LB12X8MW2S195V2	LB12X9MW2S195V2
Door / Return Pack 1950mm High White LH/RH	DG12DX8RWH195SYMP	DG12DX9RWH195SYMP
Door / Return Pack 1950mm High Silva LH/RH	DG12DX8RSI195SYMP	DG12DX9RSI195SYMP
Door / Return Pack 1950mm High Black LH/RH	DG12DX8RBL195SYMP	DG12DX9RBL195SYMP

WARRANTY INFORMATION

All bathroomware products supplied by Fibre Systems carry our Quality Assurance and Product Warranty. We use the highest quality materials available and manufacture these in accordance with New Zealand specifications and requirements to ensure that all products are fit for the intended purpose for which they are designed. Our customer's peace of mind is of paramount importance to us.

Warranty Periods

Baths	10 years
Showers	10 years
Shower Screens and Doors	10 years
Silva and White Coatings	10 years
E-Line + Squareline + Dezine Showers	5 years
Black Coatings	5 years
Aquaknight Easy Clean Wastes	7 years
Accessories	2 years

Warranty Exclusions

The product must be installed according to the instructions supplied.

The water supply temperature applied to the product must not exceed 55 degrees Celsius.

All cleaning and cleaning products must be in accordance with our cleaning instructions and guidance.

Commercial Applications (where products are installed in a building where occupancy is via a commercial arrangement i.e. a rental property, hotel, hostel etc) are restricted to a 2 year warranty on all products.



CLEANING AND MAINTENANCE

Please refer to our cleaning instructions document for guidance - available on our website.

In accordance with our continuous product development programs, Fibre Systems sizes and specifications outlined in these specifications are subject to change without notice.

Information detailed in this technical sheet represents the actual product available at the time of printing this sheet. For the latest version of this technical sheet please visit www.symphonyshowers.co.nz or contact your nearest stockist to confirm any questions prior to purchase.