

INTRODUCTION

This guide covers all Fibre Systems round corner and 2 panel sliding shower doors. The Images below show our alloy double rollers fitted to a 1950mm high model shower.

The same guide and methods of adjustment can be used to adjust our 1900mm and 1830mm high shower doors fitted with plastic bodied double and single rollers as shown to the right.

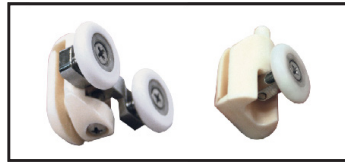

Pictured Above :
Plastic bodied double roller
top guide
+ single roller bottom guide



Pictured Above :
Plastic bodied single roller
top guide
+ single roller bottom guide

HOW DO THE ROLLERS WORK ?

TOP ROLLER

The top rollers have phillips head adjustment screws. These raise and lower the height on each side of the glass door panel. This allows adjustment overall of height, and adjustment of vertical alignment.

To **raise** the panel - turn clockwise

To **lower** the panel - turn anti clockwise.



Adjustment screw

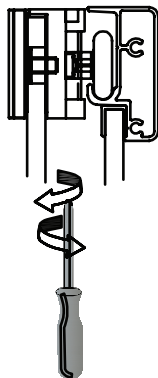

BOTTOM ROLLER

The bottom rollers have a flat surface on the chrome body. When this is pressed down, the sprung loaded roller will move downwards and disengage from the bottom framing.

The bottom rollers should be disengaged regularly to allow cleaning of the bottom framing and shower interior.

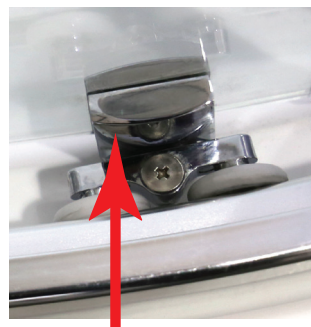

Button

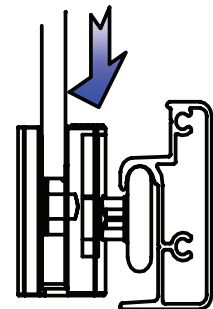

PRIMARY ADJUSTMENT



STEP 1 - DISENGAGE THE BOTTOM ROLLERS

Now you should have 2 glass door panels hanging off their top rollers with the bottom rollers resting **INSIDE** of the bottom frame. Check if the front face of all 4 rollers are resting against the frame. If one pair of rollers is not touching the frame, adjust the TOP rollers up or down until all 4 rollers are resting against the **INSIDE** of the frame. Repeat this procedure on the other door.

STEP 2 - TEST BOTH DOORS INDEPENDENTLY

To ensure that the bottom rollers engage onto the bottom frame. If they don't engage, then lower the door by adjusting both TOP rollers an equal amount of turns anti clockwise to lower the height of the door panel. Do this until the bottom rollers engage and disengage from the bottom frame comfortably.

SECONDARY ADJUSTMENT



STEP 1 - CHECK THE DOORS VERTICAL ALIGNMENT

By checking that the gap between the glass panels when both doors are in the closed position is equal from top to bottom.

If the gap is not equal than carefully adjust the rollers so that they lift or lower each side of the door panel, until the gap is equal.

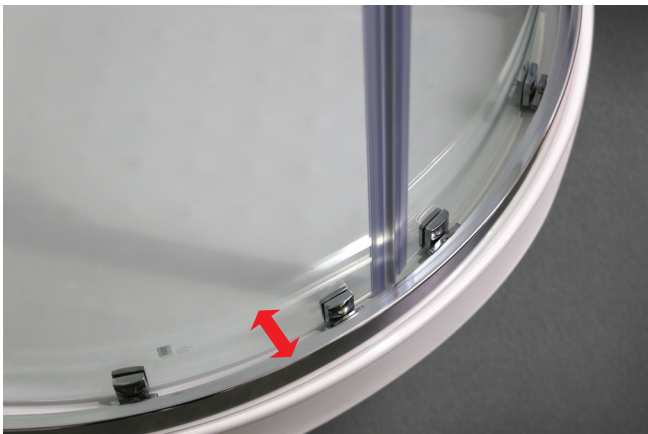

STEP 2 - CHECK FOR MOVEMENT

Between the glass panel and the frame.

Move one door panel to the open position, and move the other door panel to the closed position. Place your hand on the front of the glass panel and gently push the glass panel inward and check how much movement there is. There should be only 1-2mm movement normally. More than this means the bottom rollers are not high enough in the bottom frame, and the sliding action will not be smooth.

To reduce the amount of movement, adjust the top roller screws, equal amounts to lift the door panel height.

Check for movement again then test the sliding action of the door.

If at any stage you encounter difficulty with tight adjustment screws, lubricate with silicone spray carefully.

Please ensure to clean all excess off framing and acrylic surfaces immediately.

It is advisable to lubricate the top and bottom frame carefully with Silicone spray to allow for smooth operation of rollers. This will also extend the life of your rollers.